



Powercore Desk

Here's the low down on your desk and how to set it up.

Resetting your desk

Powercore desks need to be reset after assembly and prior to use. Follow these steps:

1. Press and hold down both the up arrows and down arrows simultaneously for 7 full seconds until the desk starts moving down.
2. Keep the buttons pressed all the way to the bottom. (The screen will show E00 just before it reaches the bottom).
3. When it reaches the bottom it will "beep" and reset. When it "beeps" you can release the buttons and it should show the height of the desk. The desk is ready to go.

If the screen shows E00 and doesn't beep, the reset hasn't been completed properly so you need to repeat the process.

When the desk goes to it's lowest level it is because the sensors are telling the controller that the desk is possibly uneven and needs to be leveled at it's bottom height.

Manually adjusting the height

Simply press the "up" or "down" arrows to go to your required height.

Setting automatic height adjustment

If you want to use the memory function to automatically move to preset heights, follow these steps:

1. Move the desk to the height you want to assign a preset memory number to.
2. Press "M" and hold it down until the screen starts flashing. Release the "M" button and select the number you want to allocate that height to (1,2,3 or 4).
3. When the P- (number allocated) shows on the screen you have successfully allocated that preset (1,2,3 or 4) to the height.
4. Move the desk to another height level and repeat the process until you have allocated all the presets to a height level.

To move the desk to a preset height level just press the number (1,2,3 or 4) and release. The desk will move to that preset height.

You can overwrite these settings any time by repeating the process and re-allocating the preset number to a different height.

Error messages

If the handset on the desk shows an error message (E - "number") it is a good chance the desk just needs a reset. Follow the instructions at the top of this page.

If the error message persists (despite the reset): email stuart@powercore.nz with the error message and I'll get in contact to help you. Most solutions are pretty simple.



Watch the assembly video: vimeo.com/371500148



Enjoy your desk
and your mobility

powercore.nz



Assembly instructions

Parts and tools list

Name	Qty	Name	Qty
1 Lifting System	1 set	8 M6*12 Screw	12
2 Feet	2	9 Rubber Cushion	6
3 M6*14 Screw	8	10 Plastic Pad	6
4 Bracket	2	11 ST3.5*19 Screw	2
5 M6*10 Screw	8	12 ST4.8*19 Screw	2
6 Support Beam	1	13 ST4.8*25 Screw	6
7 4mm Hex Spanner	1		

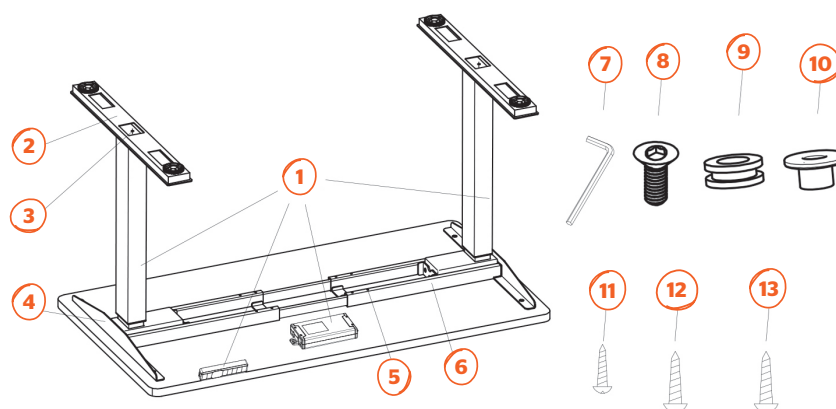

- 1 Loosen the M6*10 screw on the beam with the 4mm hexagon wrench then adjust the length of the beam according to the width of the tops you are fitting. Fix the beam length in place with the M6*10 screw. It will now be fixed at that length.

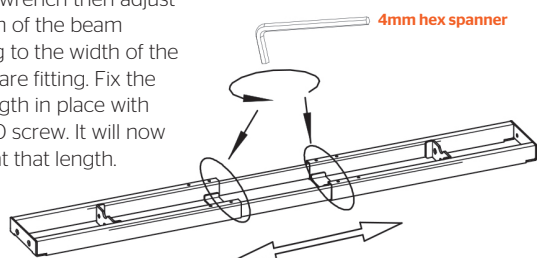

- 2 Attach legs to the beam using 8 of M6*12 screws.

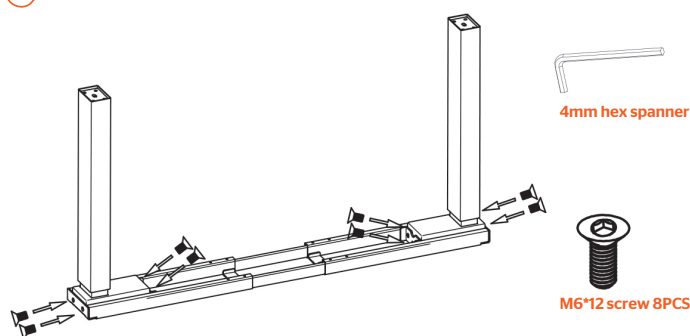

- 3 Attach feet to the legs using 8 of M6*14 screws.

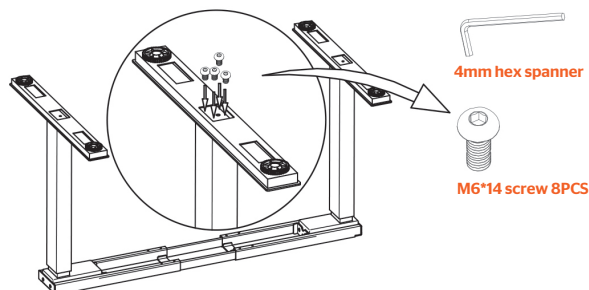

- 4 Attach brackets to beam using 4 of M6*12 screws, and then fit the rubber cushion and plastic pad to the brackets and beam.

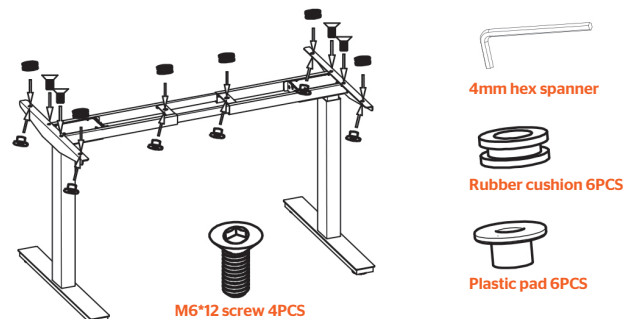

- 5 Fix table top to the frame with 6 of ST4. 8*25 screws, then fix the control box to the underside of the table top with 2 of ST4. 8*19 screws. Lastly fix the handset to the front edge with 2 of ST3. 5*19 screws.

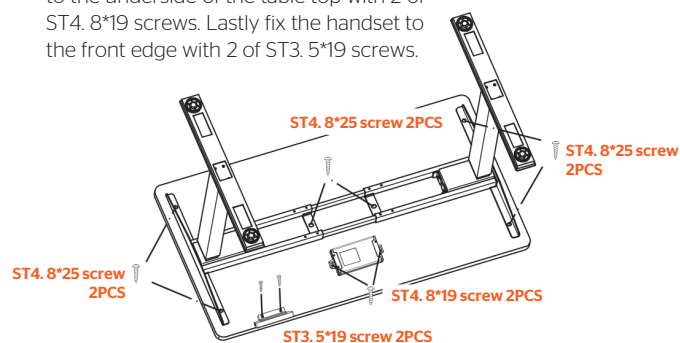

By the way, we pack one extra screw (of each type) in case you lose one when unpacking. Don't panic when you see you have an extra one.

- 6 Connect the control box to the handset and the two motors (the motors will go in either slot). Connect the power cable, plug it in and you are ready to roll.

